

N. ELEMENTO.	NUMERO PARTE
1	07-99900109 RESISTOR 2KW FRY TOP
2	08-85900009 WORKING THERMOSTAT 50-275°
3	08-85900019 SAFETY THERMOSTAT 350°
4	09-85900009 4-POLES SWITCH
5	14-99901620 GREEN WARNING LIGHT
6	14-99901621 ORANGE WARNING LIGHT
7	15-99600160 BENCH VERSION FOOT D.38
8	DRAWER
9	FRONTAL PANEL FOR BENCH VERSION
10	23-83300084 CHIMNEY GRID
11	23-99705118 CHIMNEY EXTENTION 800 LQ
12	WA-83300219 TOP 800 LQ
13	29-99701069 KNOB
14	FRONTAL PANEL
15	42-19811709 INSULATION
16	WA-99900502 SMOOTH PLATE 800x900 IN AISI 430
16	WA-99900503 RIBBED PLATE 800x900 IN AISI 430
16	WA-99900504 HALF SMOOTH HALF RIBBED PLATE 800X900 IN AISI 430
17	14-99902115 GROUNDING ELEMENT
18	14-99900750 6-POLES TERMINAL
19	15-99901801 STANDARD FOOT D.58X120-185H
20	WP-99700060 DOOR
21	23-99600400 PLATE FOR DOOR
22	56-89900013 GN 1/3 H65

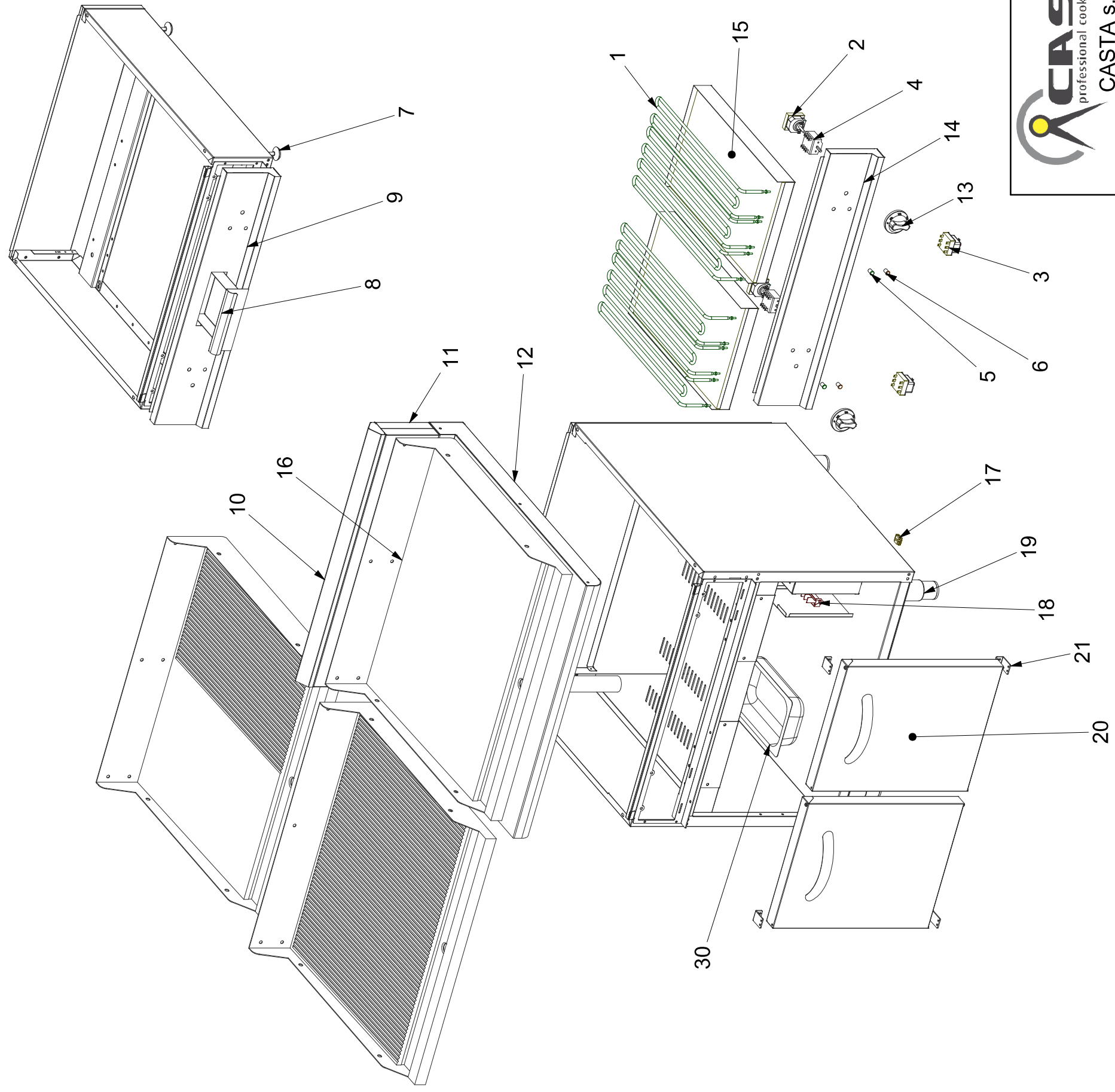

Stab. 1 e 3 - Via F.lli Lumière, 11 - Z.I. Villa Selva
 Stab. 2 - Via F.lli Lumière, 30 - Z.I. Villa Selva
 47122 Forlì - FC - IT
 www.casta.com - e-mail: casta@casta.com
 Tel. +39.0543.782920 - Fax+39.0543.782925

Ciente:

Prodotto: LQ-FTE4-RK-LK-MK BA-BB-BC

kW gas: kW elettrico:

Data: 02/12/2021 Revisione: del 10/12/2021 Scala: Designer:
 1:10 Andrea Francini

Note: