

N. ELEMENTO.	NUMERO PARTE
1	68-99700031 OVEN GRID SUPPORT
2	01-99900001 1-BURNER GRID LINE 900
3	04-99900019 VENTURI CONE FOR SMALL BURNER
4	04-99900029 VENTURI CONE FOR MEDIUM BURNER
5	04-99900039 VENTURI CONE FOR BIG BURNER
6	04-99900049 BURNER BODY FOR SMALL BURNER
7	04-99900059 BURNER BODY FOR MEDIUM BURNER
8	04-99900069 BURNER BODY FOR BIG BURNER
9	04-99900079 CAP FOR SMALL BURNER
10	04-99900089 CAP FOR MEDIUM BURNER
11	04-99900099 CAP FOR BIG BURNER
12	13-99901039 HOLDER FOR NOZZLE D.10
13	13-99901049 BRASS LOCK NUT
14	14-99900809 BUSHING AIR REGISTER D.18
15	15-99600089 FRONT MAXI OVEN PLATE
16	15-99900099 BACK MAXI OVEN PLATE
17	15-99901801 STANDARD FOOT D.58X020-185H
18	16-99600059 GAS TAP 21S
19	16-99600089 GAS TAP 25ST
20	17-12160079 3-FLAMES PILOT
21	17-12170029 SPARK PLUG
22	17-99600239 THERMOCOUPLE L=1200
23	17-99600290 EXTENSION FOR THERMOCOUPLE L=600
24	17-99900029 THREADED THERMOCOUPLE L=600
25	17-99900030 THREADED THERMOCOUPLE L=850
26	17-99900080 CABLE 1200 FOR ELECTRIC PIEZO
27	17-99900089 ELECTRIC PIEZO
28	17-99900499 1-FLAME PILOT
29	20-99600079 BURNER FOR MAXI OVEN
30	21-99600089 CHROMED GRID FOR MAXI OVEN
31	23-19892319 PLATE FOR ROLLERS' COVERING
32	23-999600211 MAXI OVEN JOINT
33	23-99701009 PILOT FIXING ELEMENT FOR SMALL BURNER
34	23-99701019 PILOT FIXING ELEMENT FOR MEDIUM BURNER
35	23-99701029 PILOT FIXING ELEMENT FOR BIG BURNER
36	23-99900709 SMALL-MEDIUM TRAY
37	23-99900719 SMALL-BIG TRAY
38	28-17610029 OVEN DOOR ROLLER
39	28-99600019 RIGHT OVEN HINGE
40	28-99600029 LEFT OVEN HINGE
41	29-99701109 KNOB FOR GAS BURNERS
42	69-99600250 SCREW FOR GRID INSTALLATION
43	69-99901929 AIR REGULATION
44	GRID FOR CHIMNEY
45	TOP 1200
46	MAXI OVEN DOOR
47	NOOZLE
48	WA-83300329 GAS RAMP
49	WD-99700070 FRONTAL PANEL
50	29-99701059 GAS OVEN KNOB
51	13-10030019 NUT Ø 10
52	14/99900049 OGIVE Ø 10

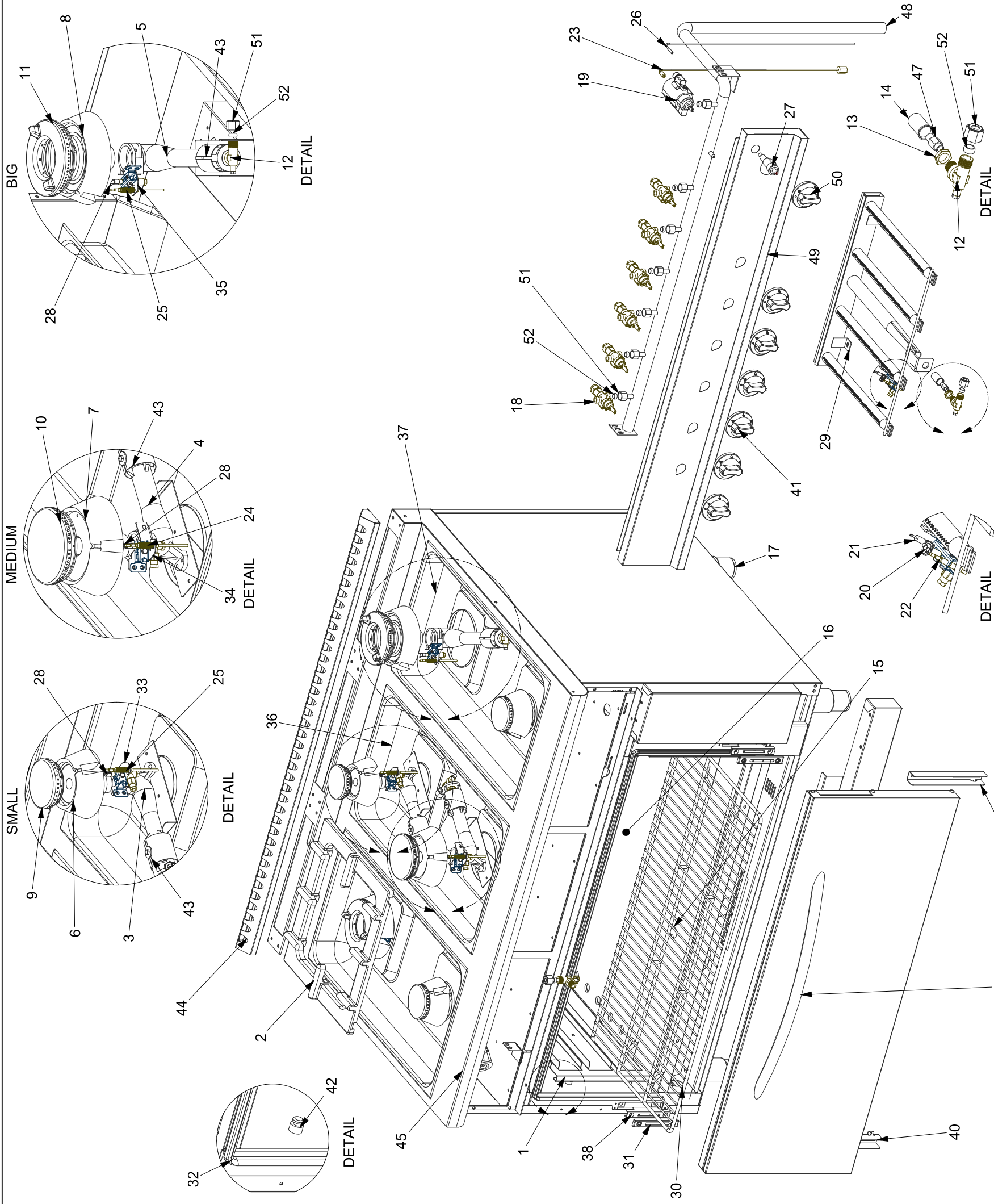

CASTA
professional cooking equipment

CASTA S.r.l.
Stab. 1 e 3 - Via F.lli Lumière, 11 - Z.I. Villa Selva
Stab. 2 - Via F.lli Lumière, 30 - Z.I. Villa Selva
47122 Forlì - FC - IT
www.casta.com - e-mail: casta@casta.com
Tel. +39.0543.782920 - Fax+39.0543.782925

Cliente:			
Prodotto: LQ-CUG6FM.3P1M2G			
kW gas:	kW elettrico:		
Data: 09/09/2021	Revisione:	del 10/12/2021	Designer: Andrea Francini
Note:			